

90 Gallon Deck Box Owner's Manual

MODEL:

IM09GY1



EAST OAK

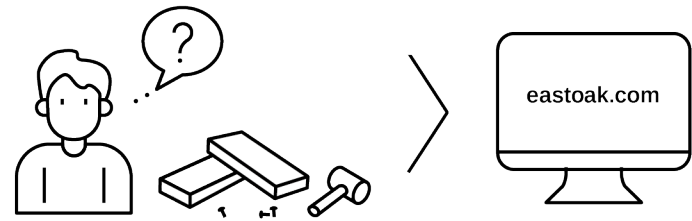

**Questions? Comments?
Reach out to us for expert support!**

✉ support@eastoak.com

🌐 eastoak.com

☎ 1-833-EAST-OAK (USA)

(1-833-327-8625) Mon-Fri 8am-8pm EST

Follow [eastoakliving](#) on



Claim your 3-year warranty
at eastoak.com/warranty

**Please scan the QR code
to view the installation video**



IMPORTANT CAUTION

Once installed, the product cannot be detached. Please strictly follow each step in the installation manual.

- Please check all parts and components to ensure that there are no damages or missing items before starting the construction of the product. If you have any problems or discover any missing parts, please contact customer service at support@eastoak.com.
- Some parts may contain sharp edges. Wear protective gloves if necessary during assembly.
- If you use power tools, please adjust the gear to the minimum, otherwise it will cause damage to the parts.

ASSEMBLY INSTRUCTIONS

- DO NOT assemble this item alone for your safety.
- We recommend using a rubber hammer and an electric screwdriver for better installation.
- Item identification: For ease of identification, all parts are labeled to correspond to the step number in which the part is used.
- **Tips: When installing the screws, fix them first, and then tighten the screws after they are all positioned.**
- The letter marks on the A/B/C/D/J panels should face inward when installing.

CARE & SAFETY

- Avoid placing products in areas with standing water, such as potholes on lawns.
- Check all panels for tightness before usage.
- It is of utmost importance to assemble all parts according to the directions. Do not skip any step.
- In case of fire, do not attempt to extinguish any burning polypropylene with water.
- Wear safety goggles and always follow the manufacturer's instructions when using power tools.
- Using a stiff brush or abrasive cleaner could damage the box.
- Hot items such as recently used grills, blowtorches, etc., must not be stored in the box.
- After rain, wipe the box with a cloth before opening it.
- Unsuitable for the storage of flammable or corrosive substances.
- Do not stand on the lid.
- To prevent the risk of suffocation, do not allow children to play inside the box.

PARTS LIST



Front Panel with Logo

A X 1 PC



Rear Panel

B X 1 PC



Left / Right Side Panel

C X 2 PCS

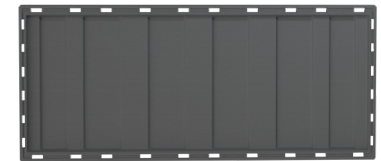

Bottom Board

D X 1 PC



Lid Panel

J X 1 PC



Reinforced Metal Rod

R X 1 PC



Hydraulic Rod

H1 X 2 PCS



Screw

M X 14 PCS + Spare X 1

1 ASSEMBLY INSTRUCTIONS

Place the Rear Panel on the ground and connect the Left and Right Side Panels with it.

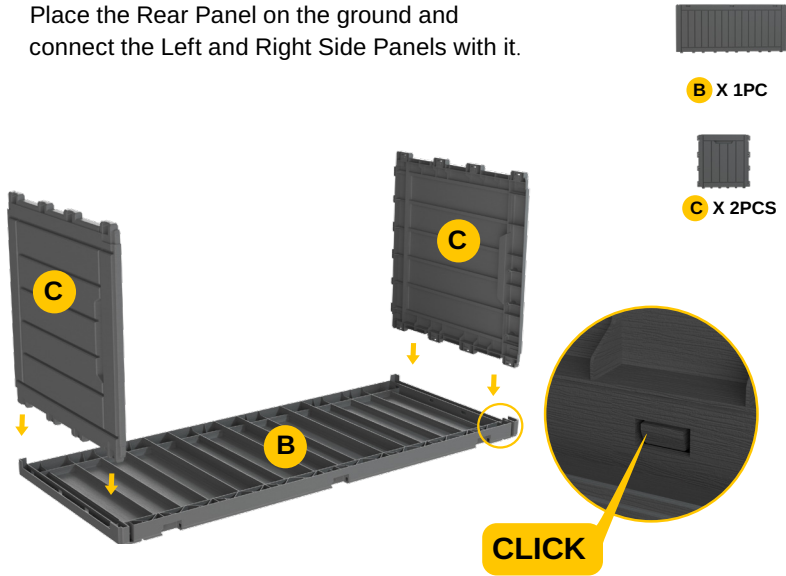

3

Put the assembled frame upside down and install the Bottom Board.

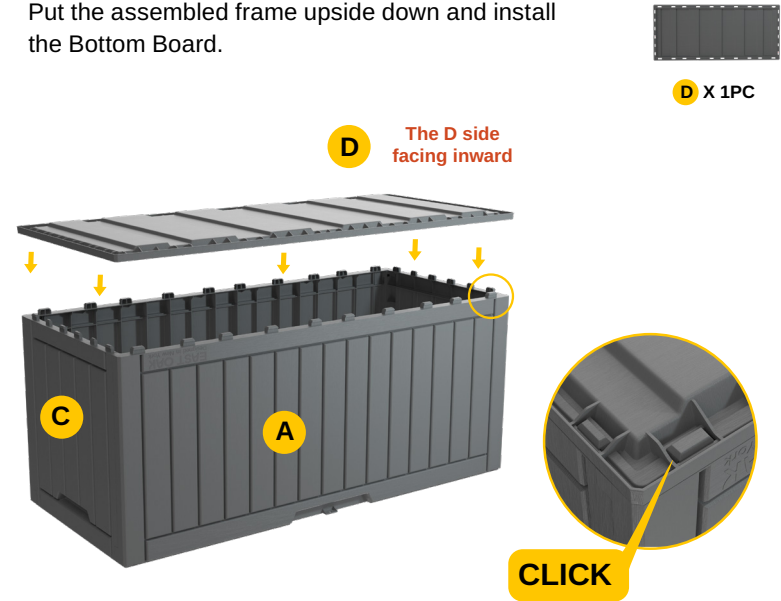

2

Buckle the Front Board on the assembled frame.

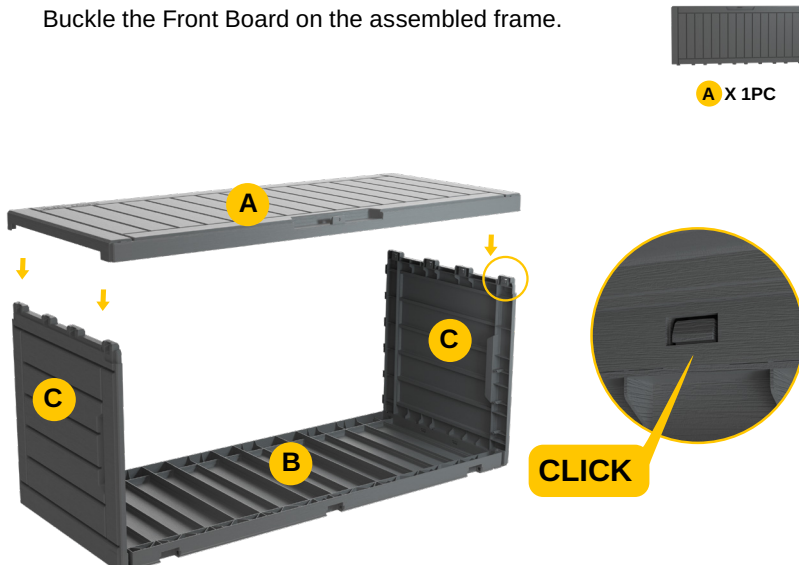

4

Please attach the Reinforced Metal Rod R to Lid Panel.

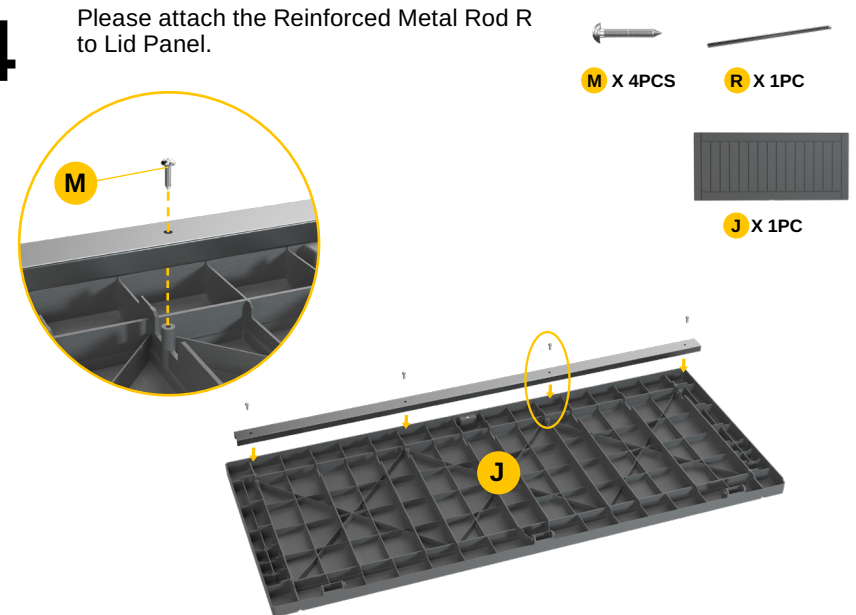

5

To install the Lid Panel, please keep the assembled frame flat, align at the holes and buckle it.



J X 1PC

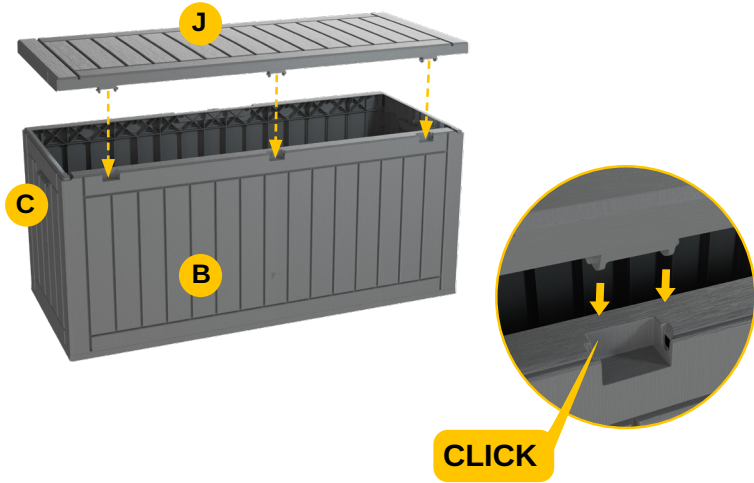

7

Assemble 2 hydraulic rods H1 to side panel C with 6 screws. Assemble 2 hydraulic rods H1 to lid panel with 4 screws.



M X 10PCS

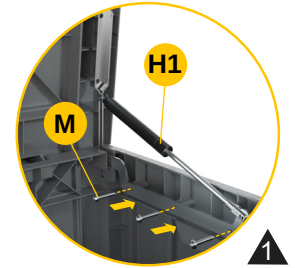
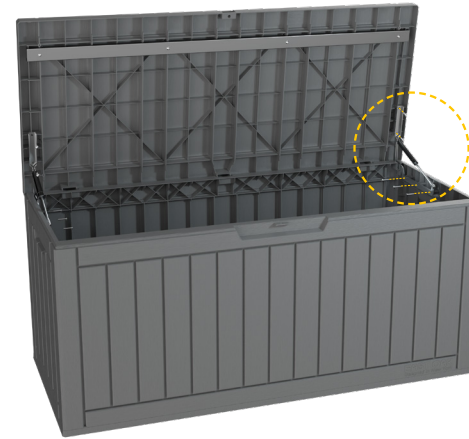

6

Install the hydraulic rod H1 in the fixed position of the side plate with the screw holes aligned.



H1 X 2PCS

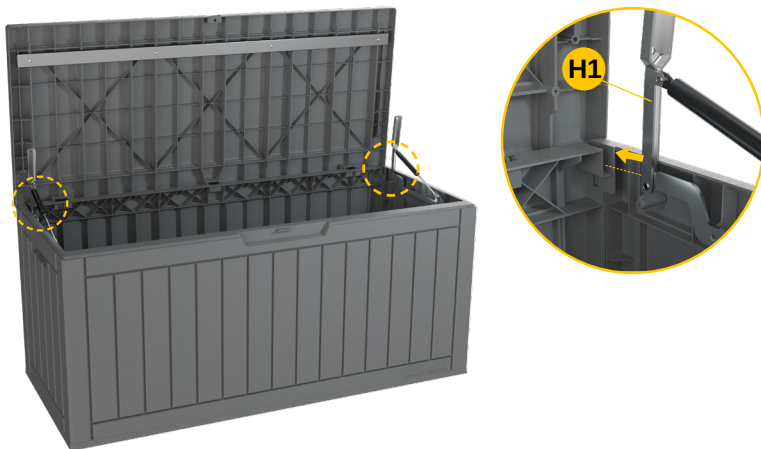

8

Installation completed.

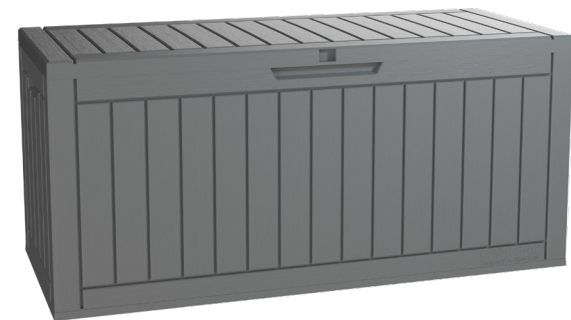

FEATURES

- Weatherproof and Waterproof Outdoor Furniture
- UV and Fade Resistant
- Durable and Long-lasting Use
- Easy to Assemble
- Comfortable Side Handles
- Upgraded PP Material to Prevent Bending and Fading
- Use for Indoors and Outdoors, Pillows, Pool Toys, Garden Tools, Furniture, and Sports Equipment
- Great Option for Home Storage and Organization

WHAT'S IN THE BOX

- 6 x Deck Box Pieces
- 1 x Reinforced Metal Rod
- 2 x Hydraulic Rod
- Screw Package
- User Manual

WARRANTY POLICY

GUARANTEED 3-YEAR WARRANTY

Thank you for choosing East Oak. This product is covered by our company warranty for up to 3 years from its original purchase date.

CLAIM WARRANTY

If you'd like to claim your product's warranty, register your new product on our website at www.eastoak.com/warranty.

WARNING

Cancer and Reproductive Harm
www.P65Warnings.ca.gov.

EAST OAK

✉ support@eastoak.com

🌐 eastoak.com

☎ 1-833-EAST-OAK (USA)